

### Parcel 048NB023 - Property Map and Details Report

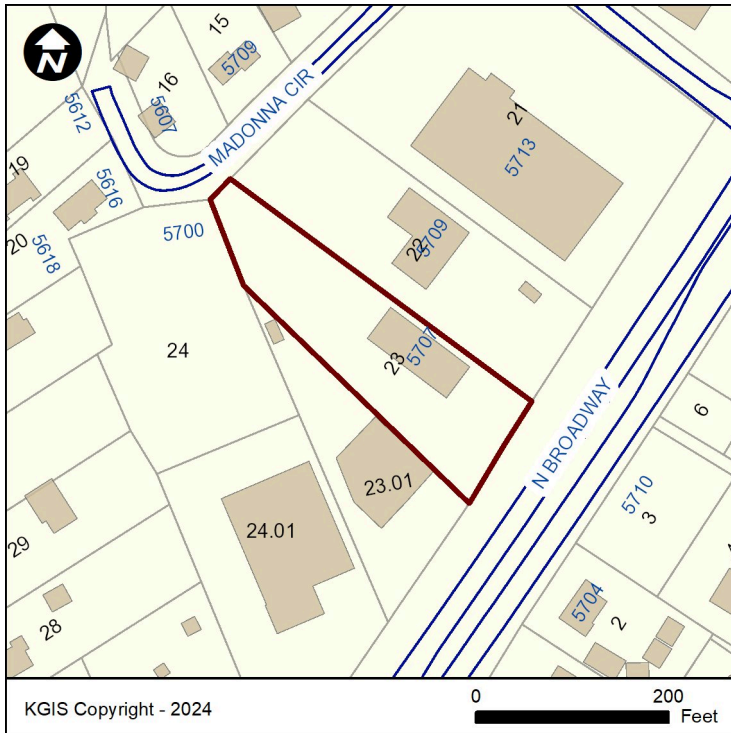

#### Property Information

Parcel ID:	048NB023
Location Address:	5707 N BROADWAY
CLT Map:	48
Insert:	N
Group:	B
Condo Letter:	
Parcel:	23
Parcel Type:	NORMAL
District:	
Ward:	36
City Block:	36760
Subdivision:	J RECTOR MYNATT
Rec. Acreage:	0
Calc. Acreage:	0
Recorded Plat:	64S - 65
Recorded Deed:	-
Deed Type:	
Deed Date:	

#### Address Information

Site Address: 5707 N BROADWAY  
KNOXVILLE - 37918

Address Type: BUSINESS

Site Name: ROWLAND TV AND APPLIANCE

Please contact Knoxville-Knox County Planning at (865) 215-2500 if you have questions.

#### Owner Information

ROWLAND WAYNE  
2008 CEDAR LN  
KNOXVILLE TN 37918

The owner information shown in this section does **not** necessarily reflect the person(s) responsible for Last Year's property taxes. Report any errors to the Knox County Property Assessor's office at (865) 215-2365.

#### Jurisdiction Information

County: KNOX COUNTY

City / Township: Knoxville

Fire Response: KNOXVILLE FIRE DEPARTMENT

Please contact the Knox County Fire Prevention Bureau at (865) 215-4640 if you have questions.

#### Other Information

Census Tract: 50

Planning Sector: North City

Please contact Knoxville-Knox County Planning at (865) 215-2500 if you have questions.

#### Political Districts

Voting Precinct: 36

Voting Location: Gresham Middle School  
500 GRESHAM RD

TN State House: 16

TN State Senate: 7

County Commission: 2 Courtney Durrett  
(at large seat 10) Larsen Jay  
(at large seat 11) Kim Frazier

City Council: 4 Lauren Rider  
(at large seat A) Lynne Fugate  
(at large seat B) Debbie Helsley  
(at large seat C) Amelia Parker

School Board: 2 Anne Templeton

Please contact Knox County Election Commission at (865) 215-2480 if you have questions.

#### School Zones

Elementary: FOUNTAIN CITY  
ELEMENTARY

Intermediate:

Middle: GRESHAM MIDDLE

High: CENTRAL HIGH

**Disclaimer:** KGIS makes no representation or warranty as to the accuracy of this map and its information nor to its fitness for use. Any user of this map product accepts the same AS IS, WITH ALL FAULTS, and assumes all responsibility for the use thereof, and further covenants and agrees to hold KGIS harmless from any damage, loss, or liability arising from any use of the map product. Independent verification of all information contained on this map should be obtained by any user.

**Proprietary Info:** The map products and databases on this Web Site have been copyrighted by the KGIS Policy Board. The KGIS Policy Board hereby reserves all rights thereto, and no portion of the products or databases on this Web Site may be reproduced in any form or by any means without the express written authorization of the KGIS Policy Board or its authorized agents.

