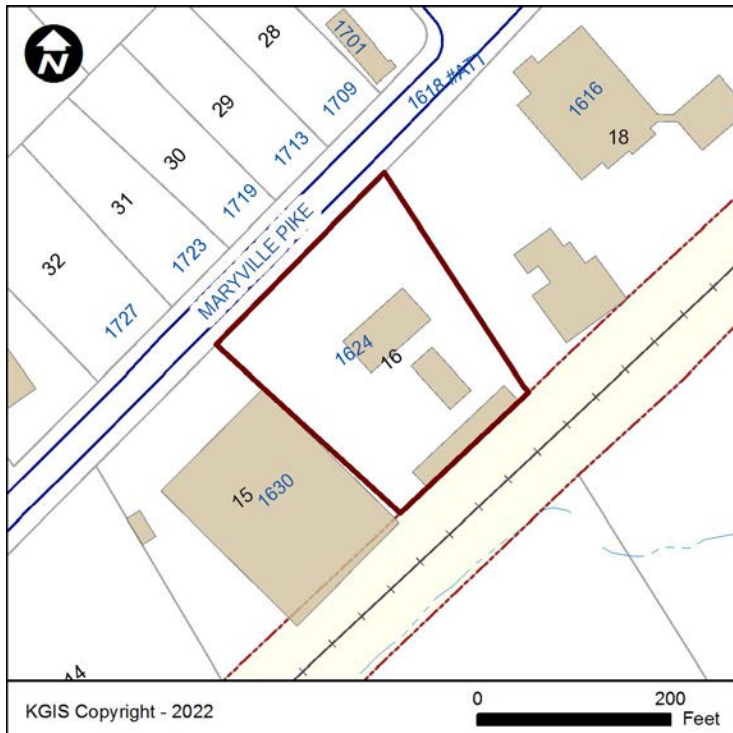

**Parcel 122NE016 - Property Map and Details Report****Property Information**

|                   |                     |
|-------------------|---------------------|
| Parcel ID:        | 122NE016            |
| Location Address: | 1624 MARYVILLE PIKE |
| CLT Map:          | 122                 |
| Insert:           | N                   |
| Group:            | E                   |
| Condo Letter:     |                     |
| Parcel:           | 16                  |
| Parcel Type:      | NORMAL              |
| District:         | D9                  |
| Ward:             |                     |
| City Block:       |                     |
| Subdivision:      |                     |
| Rec. Acreage:     | 0                   |
| Calc. Acreage:    | 0                   |
| Recorded Plat:    | -                   |
| Recorded Deed:    | 1646 - 754          |
| Deed Type:        | Deed:Deed           |
| Deed Date:        | 6/6/1978            |

**Address Information**

Site Address: 1624 MARYVILLE PIKE  
KNOXVILLE - 37920

Address Type: ACCESSORY STRUCTURE

Site Name: RIMMER BROS TRUCK PARTS

Please contact Knoxville-Knox County Planning at (865) 215-2500 if you have questions.

**Owner Information**

RIMMER BROTHERS TRUCK PARTS INC  
1616 MARYVILLE PIKE  
KNOXVILLE TN 37920

The owner information shown in this section does **not** necessarily reflect the person(s) responsible for Last Year's property taxes. Report any errors to the Knox County Property Assessor's office at (865) 215-2365.

**Jurisdiction Information**

County: KNOX COUNTY

City / Township:

**Other Information**

Census Tract: 35.01

Planning Sector: South County

Please contact Knoxville-Knox County Planning at (865) 215-2500 if you have questions.

**Political Districts**

Voting Precinct: 89

Voting Location: Mt. Olive School  
2507 MARYVILLE PIKE

TN State House: 18

TN State Senate: 6

County Commission: 9 Carson Dailey  
(at large seat 10) Larsen Jay  
(at large seat 11) Justin Biggs

School Board: 9 Kristi Kristy

Please contact Knox County Election Commission at (865) 215-2480 if you have questions.

**School Zones**

Elementary: MOUNT OLIVE ELEMENTARY

Intermediate:

Middle: SOUTH-DOYLE MIDDLE

High: SOUTH-DOYLE HIGH

Please contact Knox County Schools Transportation and Zoning Department at (865) 594-1550 if you have questions.

**Disclaimer:** KGIS makes no representation or warranty as to the accuracy of this map and its information nor to its fitness for use. Any user of this map product accepts the same AS IS, WITH ALL FAULTS, and assumes all responsibility for the use thereof, and further covenants and agrees to hold KGIS harmless from any damage, loss, or liability arising from any use of the map product. Independent verification of all information contained on this map should be obtained by any user.

**Proprietary Info:** The map products and databases on this Web Site have been copyrighted by the KGIS Policy Board. The KGIS Policy Board hereby reserves all rights thereto, and no portion of the products or databases on this Web Site may be reproduced in any form or by any means without the express written authorization of the KGIS Policy Board or its authorized agents.