

Monday, June 21, 2010

6600 Lillian Dr, Knoxville, TN 37920-6543
Knox County, TN parcel# 124JC025

Property Report

Location

Property Address 6600 Lillian Dr
Knoxville, TN 37920-6543
Subdivision Unit 2 Creswells
County Knox County, TN

Current Owner

Name Wilson Mary Ruth
Mailing Address 6600 Lillian Dr
Knoxville, TN 37920-6543

Property Summary

Property Type Residential
Land Use 1 Family
Improvement Type Res Ranch
Square Feet 1776 sf

General Parcel Information

Parcel/Tax ID 124JC025
Alternate Parcel ID 5680523817
Account Number
District/Ward D9
Census Tract/Block 34.00/1

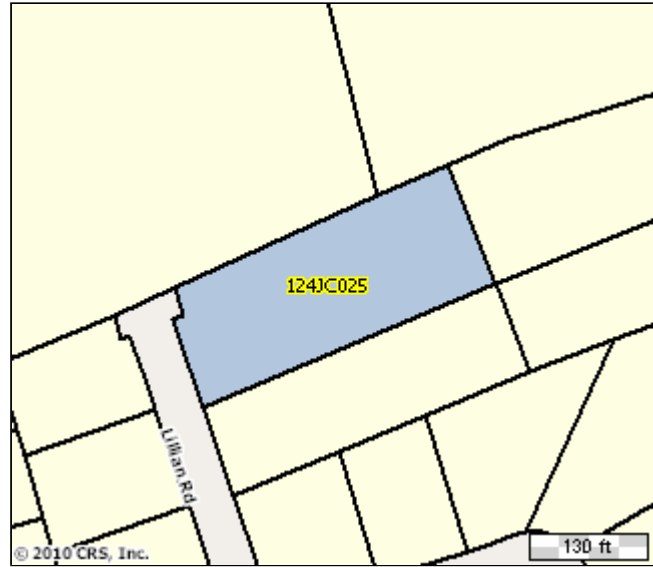

Sales History through 05/27/2010

| Date | Amount | Buyer/Owners | Buyer/Owners 2 | Instrument | Quality | Book/Page or Document# |
|------------|--------|------------------|----------------|------------|---------|------------------------|
| 11/11/1985 | | Wilson Mary Ruth | | | | 1865/504 |

Tax Assessment

| Appraisals | Amount | Taxes | Amount | Jurisdiction | Rate |
|------------------------|-----------|---------------|----------|--------------|-------|
| Tax Year | 2009 | City Taxes | \$0 | Knox | 2.360 |
| Appraised Land | \$15,000 | County Taxes | \$672.01 | | |
| Appraised Improvements | \$98,900 | Total Taxes | \$672.01 | | |
| Total Tax Appraisal | \$113,900 | Exempt Amount | | | |
| Total Assessment | \$28,475 | Exempt Reason | 00 | | |

Mortgage History

| Date | Loan Amount | Borrower | Lender | Book/Page or Document# |
|----------|-------------|------------------------------------|---------------------|------------------------|
| 1/8/2002 | \$25,000 | Wilson James E Wilson Mary Ruth | First American Bank | 200201080055411 |

Property Characteristics: Building

| Building # | Type | Condition | Sq Feet | Year Built | Effective Year | BRs | Baths | Rooms | Stories | Units |
|--|-----------|-----------|---------|------------------------------|-------------------------------------|-----|-------|-------|---------|-------|
| 1 | Res Ranch | Good | 1776 | 1962 | | 3 | 1F 1H | 6 | 1 | |
| Building Square Feet (Living Space) | | | | | Building Square Feet (Other) | | | | | |
| First Story (Base) | | | 1176 | Basement (unfinished) | | | 576 | | | |
| Basement (finished) | | | 600 | Additional Main | | | 600 | | | |
| | | | | Additional Main | | | | | | |

Construction

| | | | |
|------------|---------|------------------|---------|
| Quality | Average | Roof Framing | |
| Shape | | Roof Cover Deck | Asphalt |
| Partitions | | Cabinet Millwork | |

| | | | |
|---------------------------|----------|-----------------------------|---------------------|
| Common Wall | | Floor Finish | |
| Foundation | Full Bmt | Interior Finish | |
| Floor System | | Air Conditioning | Central |
| Exterior Wall | Brick | Heat Type | Heat & Cooling Pkg. |
| Structural Framing | | Bathroom Tile | |
| Fireplace | | Plumbing Fixtures | 7 |
| Other | | | |
| Occupancy | | Building Data Source | |

Property Characteristics: Extra Features

| Feature | Size or Description | Year Built | Condition |
|----------------|----------------------------|-------------------|------------------|
| Pool | 18X36 | 1984 | Average |
| Shed | 8X10 | 1980 | |
| Open Porch | 24 | | |
| Covr Porch | 100 | | |
| Scr Porch | 100 | | |
| Garage | 30X40 | 2005 | Average |

Property Characteristics: Lot

| | | | |
|---------------------------|------------------------|------------------------|-------------------|
| Land Use | 1 Family | Lot Dimensions | 104.4 X 345 X IRR |
| Block/Lot | A/ 11 | Lot Square Feet | |
| Latitude/Longitude | 35.922221°/-83.857279° | Acreage | |

Property Characteristics: Utilities/Area

| | | | |
|------------------------|--|----------------------------------|--|
| Gas Source | | Road Type | |
| Electric Source | | Topography | |
| Water Source | | District Trend | |
| Sewer Source | | Special School District 1 | |
| Zoning Code | | Special School District 2 | |
| Owner Type | | | |

Legal Description

| | | | |
|-----------------------|------------------|-----------------------|---|
| Subdivision | Unit 2 Creswells | Plat Book/Page | 26/242 |
| Block/Lot | A/ 11 | Description | |
| District/Ward | D9 | | |
| Monday, June 21, 2010 | | | 6600 Lillian Dr, Knoxville, TN 37920-6543 Knox County, TN parcel# 124JC025 |

COPYRIGHT © 2010 COURTHOUSE RETRIEVAL SYSTEM. ALL RIGHTS RESERVED.
Information Deemed Reliable But Not Guaranteed.
Contact Us at (800) 374-7488 ext 3 for Help.