

KGIS - Knoxville, Knox County, K.U.B. Geographic Information System

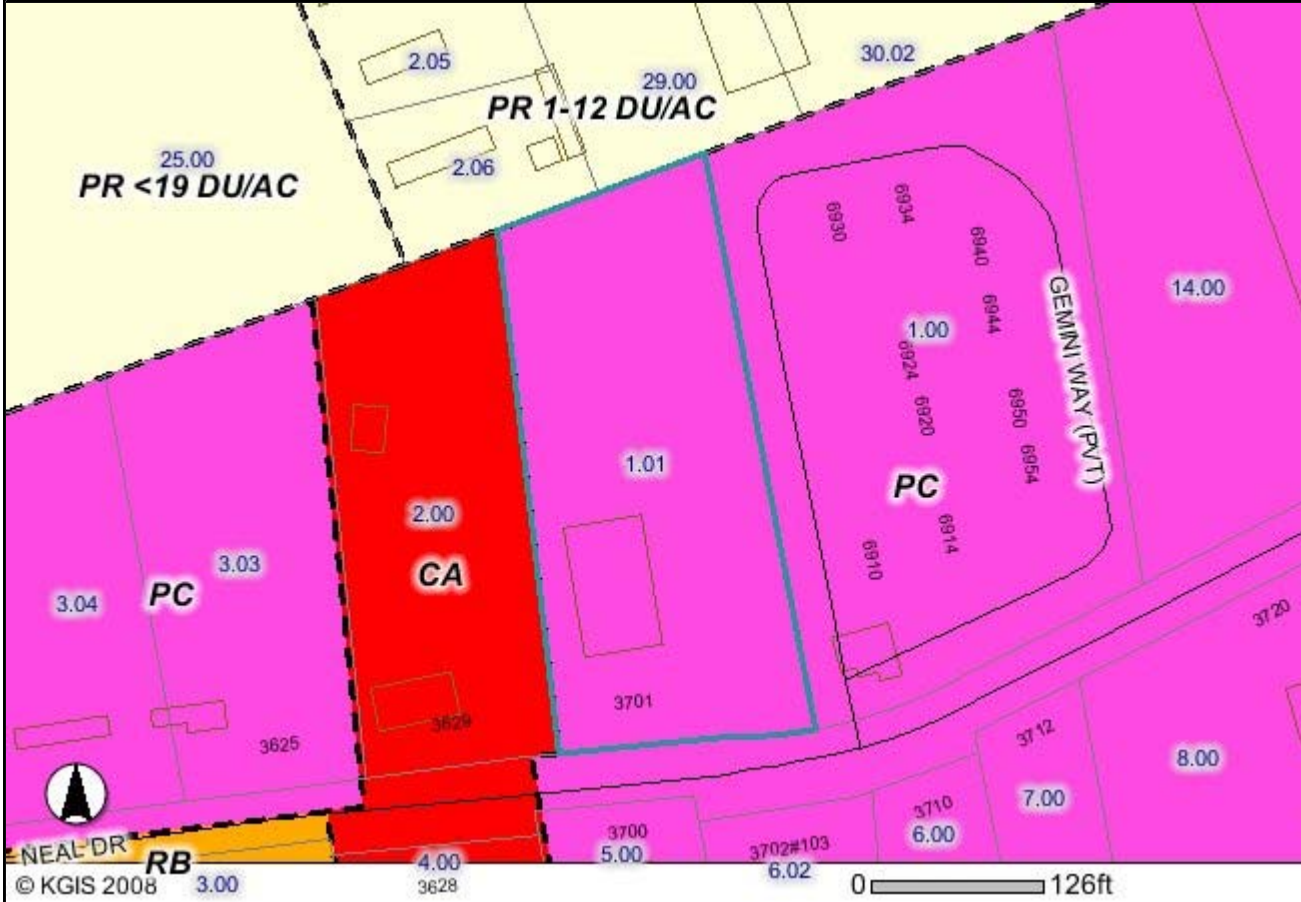

Legend

 Selected Features	 Neighborhood Conservation	 Water Bodies
 Local Roads	 Technology	 Subdivisions
 Collectors	Knox County Zoning	 Knoxville City Boundary
Arterials	 Agricultural and Estate	 Farragut Boundary
 PAPER	 Business and Technology Park	 Knoxville County Boundary
 CLOSED	 Neighborhood Commercial	
 Other	 Central Business District	
 Expressways	 Commercial	
Interstate Shield	 PLANNED COMMERCIAL	
 Interstates	 Floodway	
 Railroads	 HISTORIC OVERLAY	
 Buildings	 Industrial	
 Parcels	 Light Industrial	
 MPC Flood Fringe	 Office	
 Zoning Boundary	 Open Space	
Zoning Overlay	 Planned Residential	
 Downtown Design	 Low Density Residential	
 Flood Zone	 Multifamily Residential	
 Infill House	No Zone or Transition	
 Historic	 FORM DISTRICT	
(cont)	 TRADITIONAL NEIGHBORHOOD DEVELOPMENT AND TOWN CENTER	

Disclaimer. KGIS makes no representation or warranty as to the accuracy of this map and its information nor to its fitness for use. Any user of this map product accepts the same AS IS, WITH ALL FAULTS, and assumes all responsibility for the use thereof, and further covenants and agrees to hold KGIS harmless from and any damage, loss, or liability arising from any use of the map product. Independent verification of all information contained on this map should be obtained by any user.

Proprietary Information. The map products and databases on this Web Site have been copyrighted by the KGIS Policy Board. The KGIS Policy Board hereby reserves all rights thereto, and no portion of the products or databases on this Web Site may be reproduced in any form or by any means without the express written authorization of the KGIS Policy Board or its authorized agents.

NOTE: These maps show zoning boundaries adopted by the Knox County Board of Commissioners on April 17, 1979 and the Knoxville City Council on August 19, 1980, and subsequently amended. Official maps are available for inspection in the Metropolitan Planning Commission offices. The zoning maps are amended frequently through action of the City Council and County Commission. Therefore, recent zoning changes that have been approved by the City Council or County Commission may not be reflected here. Verify all zoning with the Knoxville-Knox County Metropolitan Planning Commission staff at (865) 215-2500.