

LEGEND

- 320 — AVERAGE DAILY TRAFFIC VOLUME
- 49 — INTERSTATE HIGHWAY SYSTEM
- 75 — U.S. NUMBERED HIGHWAY SYSTEM
- 170 — U.S. NUMBERED HIGHWAY SYSTEM
- 61 — STATE SECONDARY HIGHWAY SYSTEM
- 62 — STATE PRIMARY HIGHWAY SYSTEM
- 115 — LOCAL ROAD OR STREET
- — COUNTY LINE
- — STATE LINE
- — INCORPORATED CITY BOUNDARY
- — RESERVATION BOUNDARY
- — WIDE STREAM
- 000 — STATION NUMBER

2008 TRAFFIC MAP
OAK RIDGE
 TENNESSEE

TENNESSEE DEPARTMENT OF TRANSPORTATION
 LONG RANGE AND PROJECT PLANNING DIVISIONS
 U.S. DEPARTMENT OF TRANSPORTATION
 FEDERAL HIGHWAY ADMINISTRATION

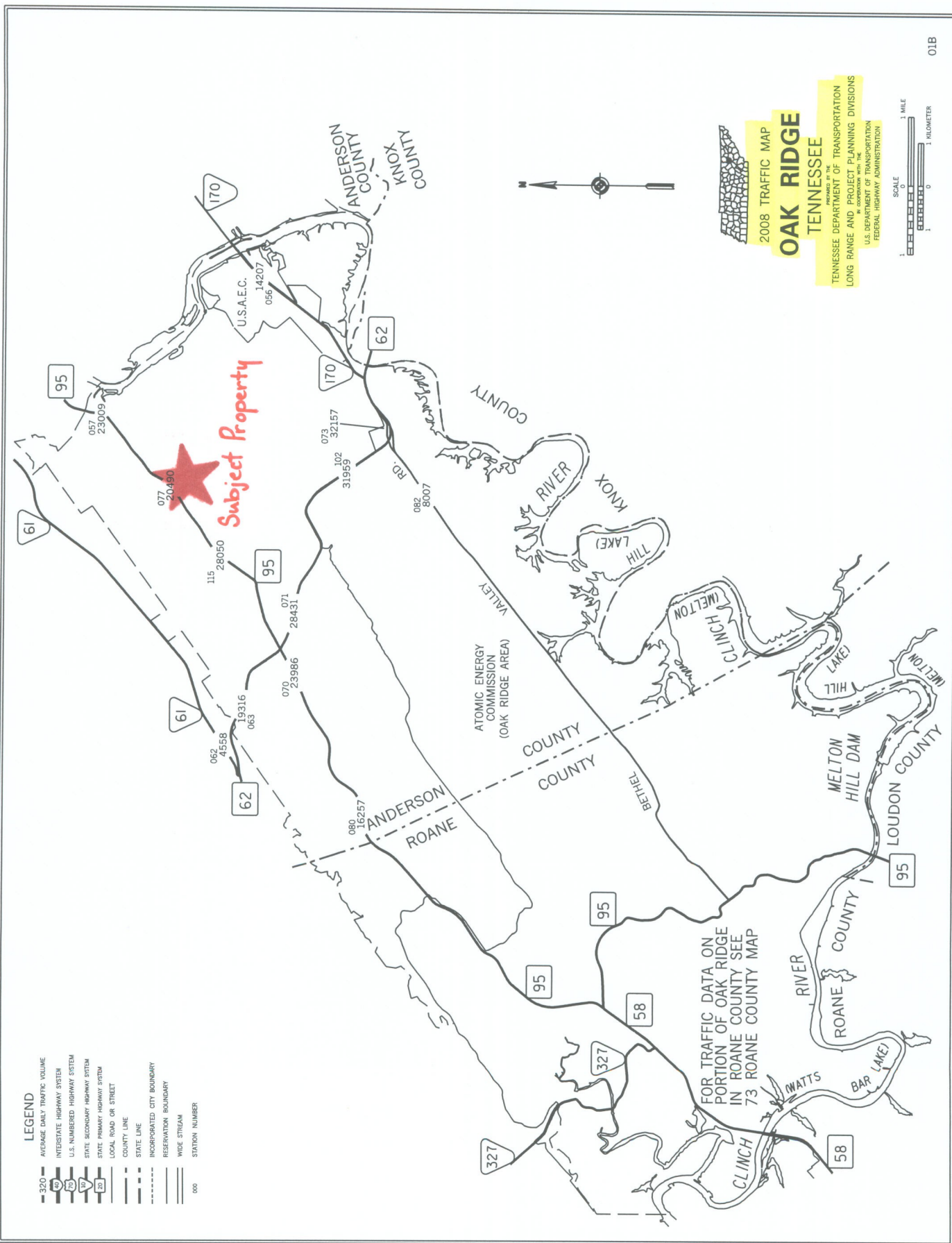
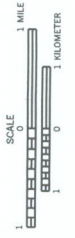

FOR TRAFFIC DATA ON
 PORTION OF OAK RIDGE
 IN ROANE COUNTY SEE
 73 ROANE COUNTY MAP