

MAP
 OF
THE HOME REAL-ESTATE & IMPROVEMENT CO'S
 SECOND ADDITION
 TO
ELIZABETHTON, TENNESSEE
 SCALE 1 IN. = 100 FT.
 J.R. FLETCHER C.E.

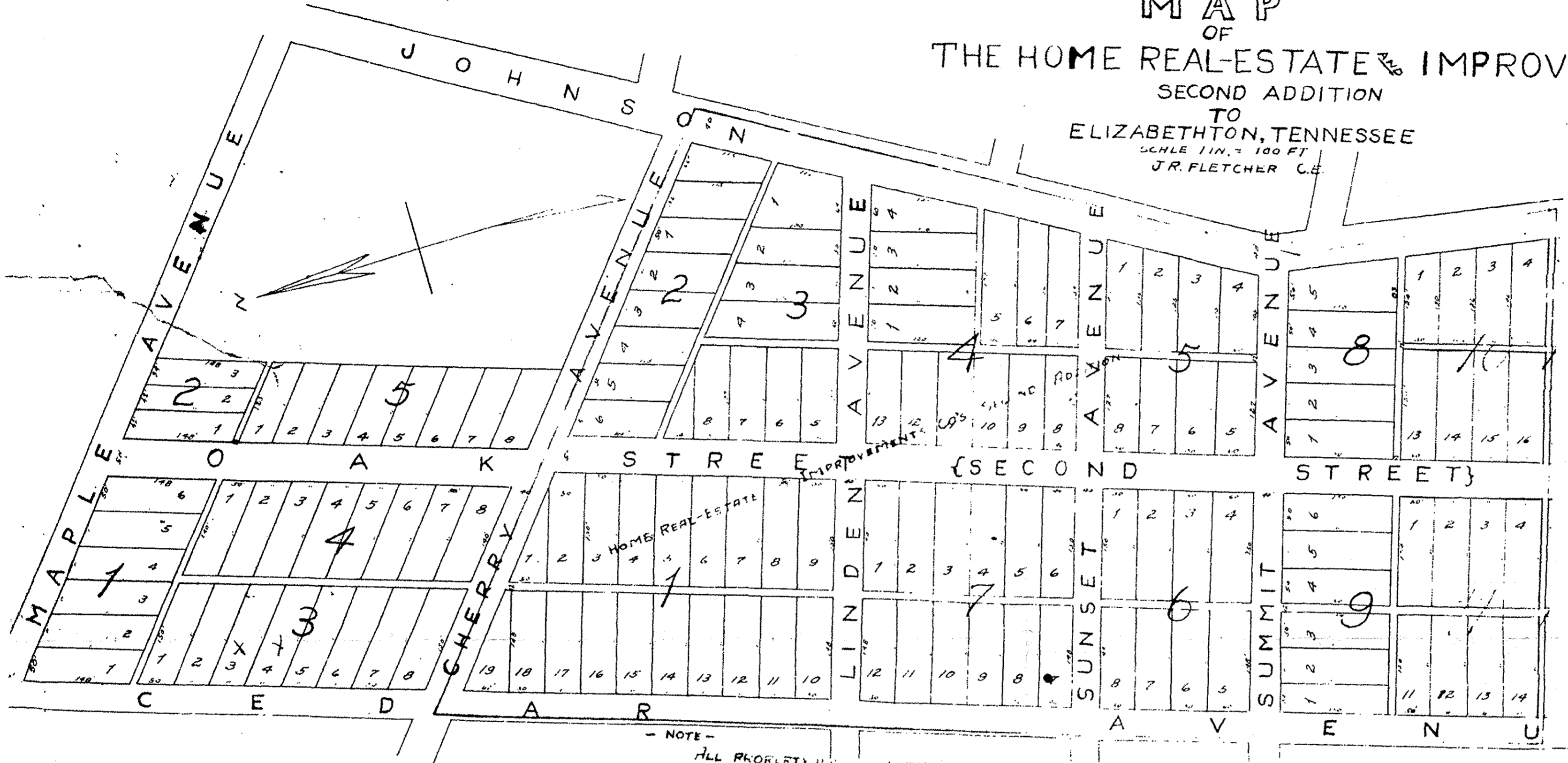

- NOTE -
 ALL PROPERTY SHOWN ON THIS MAP IS THE PROPERTY OF THE HOME REAL-ESTATE & IMPROVEMENT CO'S SECOND ADDITION

J. Frank Seiler

STATE OF TENNESSEE - DEPUTY COUNTY CLERK
 I have this day filed for record the above and certified a true and correct copy to the proper authorities.
 Witness my hand and the seal of said office this 19th day of August 1913.
 J. Frank Seiler
 Deputy County Clerk