

1632 DRY GAP PIKE - Property Map and Details Report

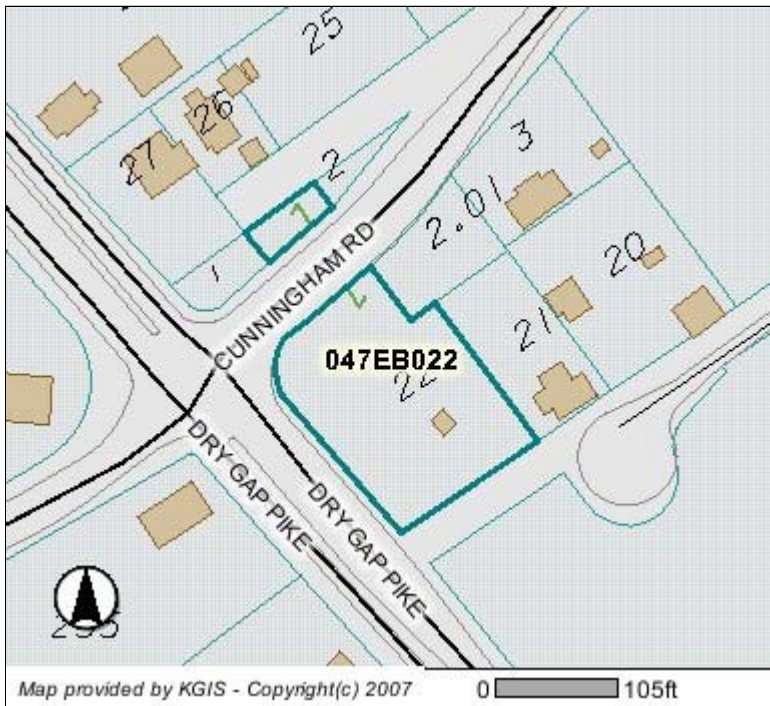

Parcel Information (last updated: 2/6/2010)

Location Address: 1632 DRY GAP PIKE
 CLT Map: 047
 Insert: E
 Group: B
 Condo Letter:
 Parcel: 022
 Parcel ID: 047EB022
 Parcel Type: NORMAL DISJ
 District: E6
 Ward:
 Subdivision: BEAVERDALE PTS
 1,2,3
 Recorded Acreage: 0.00
 Calculated Acreage: 0.00
 Recorded Plat: 12 - 6
 Recorded Deed: 20080627 - 0097488
 Deed Type: QUIT CLAIM
 Deed Date: 06/27/2008

Address Information (last updated: 2/6/2010)

Site Address: 1632 DRY GAP PIKE
 KNOXVILLE - 37918
 Address Type: RESIDENTIAL
 Site Name:

Owner Information (last updated: 2/6/2010)

CROWE DANIEL BRUCE
 5408 HEATHROW DR
 KNOXVILLE, TN 37919

The owner information shown in this section does **not** necessarily reflect the person(s) responsible for Last Year's property taxes. Report any errors to the Knox County Property Assessor's office at (865) 215-2365.

Jurisdiction (last updated: 2/13/2009)

County: KNOX COUNTY
 City / Township:

MPC Info (last updated: 10/25/2006)

Census Tract: 62.04
 Planning Sector: North County
 1990 Traffic Zone: 192
 2000 Traffic Zone: 192
 Please contact Knox County Metropolitan Planning Commission (MPC) at (865) 215-2500 if you have questions.

Political Districts (last updated: 1/5/2008)

Voting Precinct: 59 Brickey
 Voting Location: Brickey School
 1810 DRY GAP PIKE
 TN State House: 16 Bill Dunn
 TN State Senate: 5 Randy McNally
 County Commission: 7 Larry Smith
 Michele Carringer
 City Council:
 School Board: 7 Rex Stooksbury

School Zones (last updated: 5/27/2009)

Elementary: BRICKEY MC CLOUD ELEMENTARY
 Middle: HALLS MIDDLE
 High (2007): HALLS HIGH
 High (2008):

Please contact Knox County Schools Transportation and Zoning Department at (865) 594-1550 if you have questions.

Please contact Knox County Election Commission at (865) 215-2480 if you have questions.

Disclaimer. KGIS makes no representation or warranty as to the accuracy of this map and its information nor to its fitness for use. Any user of this map product accepts the same AS IS, WITH ALL FAULTS, and assumes all responsibility for the use thereof, and further covenants and agrees to hold KGIS harmless from any damage, loss, or liability arising from any use of the map product. Independent verification of all information contained on this map should be obtained by any user.

Proprietary Information. The map products and databases on this Web Site have been copyrighted by the KGIS Policy Board. The KGIS Policy Board hereby reserves all rights thereto, and no portion of the products or databases on this Web Site may be reproduced in any form or by any means without the express written authorization of the KGIS Policy Board or its authorized agents.